



PRODUCT SPECIFICATION

PLUG METRIC SLEEVE MTME

TYPE	COMPOSITION	D	d1	d2	TOLER. mm	L	TOLER. LENGTH	UNITS/ BOX	COLOUR
AISCAN-MTME-16	STEEL	18,3	16,2	15,5	+0,2	45	+1	100	ZINC
AISCAN-MTME-20	“	22,3	20,3	19,5	+0,2	50	+1	100	“
AISCAN-MTME-25	“	28	25,3	24,5	+0,2	55	+1	60	“
AISCAN-MTME-32	“	35,4	32,3	31,5	+0,2	65	+1	30	“
AISCAN-MTME-40	“	43,4	40,5	39,5	+0,2	70	+1	25	“
AISCAN-MTME-50	“	53,4	50,5	49,5	+0,2	90	+1	12	“
AISCAN-MTME-63	“	67	63,6	62,4	+0,2	105	+1	6	“
EDITION DATE	EDITION NUMBER	CARD NUMBER							
2009/02	2	EP-MTME							

- THESE ACCESSORIES ARE USED IN NO THREADABLES METRICS TUBES IN ACCORDING TO UNE-EN 60423

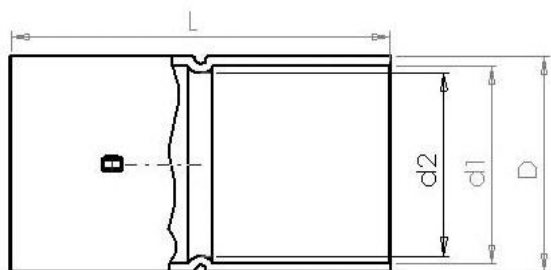

SPECIFICATIONS ACCORDING TO STANDARD UNE-EN 61386-21

- CODE: 555711542010
- OPERATING TEMPERATURE RANGE: -45 + 400°C
- CRUSHING STRENGTH: > 4000N
- IMPACT RESISTANCE: >20J AT -45°C
- CORROSION RESISTANCE: MEDIUM
- FLAME PROPAGATE: NO
- MATERIAL: COLD ROLLED STEEL WITH LOW CONTENT CARBON. QUALITY TYPE DC03, IN ACCORDING TO STANDARD EN-10130. ELECTRO-GALVANIZED FINISH.

- NO CONTROLLED COPY. THIS INFORMATION COULD BE MODIFIED BY AISCAN WHITOUT PREVIOUS ADVERTISMENT.-